

# Combine Sickle Repairs (OEM Style) - Agco Gleaner & Challenger

## Sections and Section Bolts

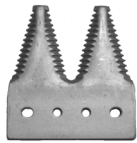
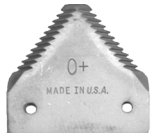

ORDER NO.	DESCRIPTION	STOCK	RETAIL
K412051 (25/box)	Single point section, Kondex no. 432-051 extra heavy, chrome, top serrated section. Fits 300, 500, 700, 800 series heads with bolt on sections. 2" hole spacing. 2-7/8" long x 3" wide. Big Tooth.	8118	\$1.69
BDC6700B (25/box)	Double point section. Replaces Agco no. 71353125. Fits all heads with Clean Cut system. Big Tooth.	887	\$1.25
KDC55	Section bolts and nuts, for use with single point or double point sections, 5/8" long, box of 50.	8465	\$9.26
KDC55114	Section bolts and nuts, for use with single point or double point sections, 1-1/4" long, box of 25.	4253	\$7.50

## Guards, Hold Down Clips, Wear Plates



ORDER NO.	DESCRIPTION	STOCK	RETAIL
BU325	Double prong guard, Replaces AC no. 71341601 & 7116504. Fits all Agco 300, 500, 700, 800 series flex heads and Challenger.	1689	\$12.30
K5116	Hold down clip, fits all flex heads and early rigid heads. For use with riveted or bolted sickles.	9139	\$4.56
BDC5150H	High arch hold down clip for use at the drive head area. Fits all flex heads and early rigid heads.	4635	\$5.20
SDC468	Steel wear plate, replaces AC no. 711766537. Fits all Gleaner heads.	3318	\$1.90
BDC5066	Four prong bottom guard. Fits all Gleaner flex heads with Clean Cut system & Challenger	5496	\$13.50
BDC5166	Two prong top guard. Fits all Gleaner flex heads with Clean Cut system. Replaces AC no. 71345591. Also fits Challenger.	3095	\$12.90

## Sickle Bar Drive Head

ORDER NO.	DESCRIPTION	STOCK	RETAIL
K901118	Drive head, series 3 (late) and 500 ser.	08562	\$94.00



## Sickles - Split, without drive head - Can ship UPS

To fit Agco OEM guards with 3" cutting systems.

ORDER NO.	DESCRIPTION	STOCK	RETAIL
CR28785	Split sickle, 20' with big tooth sections.	000038	\$375.00
CR24074	Split sickle, 25' with big tooth sections.	000439	\$425.00
CR28789	Split sickle, 30' with big tooth sections.	008638	\$460.00

# Combine Sickle Repairs (OEM Style) - Case-IH

## Sections and Section Bolts

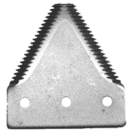

ORDER NO.	DESCRIPTION	STOCK	RETAIL
K231271 (25/box)	Single point section, black, "Big Tooth", top serrated, extra heavy. Replaces Case-IH no. 596321R3 & 826720C2. Used on 820, 1010, 1020, 2010, 2020. 3" wide x 3-1/4" long, <b>3 holes</b> .	099	\$1.29
KDC55	Section bolts and nuts, for use with single point sections, 5/8" long, box of 50.	8465	\$9.26
KDC5501	Section bolts and nuts, 1" long box of 25.	8744	\$6.83
KDC55114	Section bolts and nuts, for use with single point sections, 1-1/4" long, box of 25.	4253	\$7.50

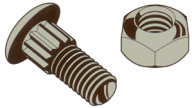

## Guards

ORDER NO.	DESCRIPTION	STOCK	RETAIL
BU270	Double prong guard, fits all 820 flex heads that use guards equipped with cross bar. Replaces IH no. 613838R3 and 187350A1.	51019	\$14.50
BU299	Double prong guard, fits all Case-IH 1020; 2020 s/n CBJ020001 and above. Replaces Case-IH numbers 1307299C2 and 334305A1.	4095	\$12.91
BU210	Double prong guard used at drive head area (3 pcs.) on model 1020 with cross bar. Replaces Case-IH numbers 1326787C3, 483500R4, and 187346A1.	34014	\$14.90
BU329	Double prong guard used at drive head area (3 pcs.) on model 1020 without cross bar.	34018	\$14.90
BU973	Double prong guard for model 3020, NH740C. Replaces CNH no. 87702973.	51017	\$14.50
BU289	Single prong end guard, 2 used on 1020. Replaces CIH no. 1338269C1.	0248	\$6.00
BU215	Double prong guard. Fits Case-IH platforms 2010 and 2020 prior to s/n CBJ020000 or with s/n's that start with HAJ. Replaces CIH part no. 700707147, 86615982.	7198	\$13.10



## Hold Down Clips, Wear Plates

ORDER NO.	DESCRIPTION	STOCK	RETAIL
K5116	Hold down clip, fits all flex heads and early rigid heads. For use with riveted or bolted sickles.	9139	\$4.56
BDC5150H	High arch hold down clip for use at the drive head area. Fits all flex heads and early rigid heads.	4635	\$5.20
SDC468	Steel wear plate.	3318	\$1.90

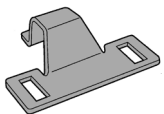

## Sickles for 3" OEM Cutterbars

ORDER NO.	DESCRIPTION	STOCK	RETAIL
CR19912	Split sickle, complete for 1020, 20', single pt. Does not include head.	004628	\$330.00
CR19914	Split sickle, complete for 1020, 25', single pt. Does not include head.	002339	\$415.00
CR19915	Split sickle, complete for 1020, 30', single pt. Does not include head.	000638	\$450.00
CR19449	Split sickle, complete for 820, 17.5', single pt. Does not include head.	002326	\$290.00
CR19450	Split sickle, complete for 820, 20', single pt. Does not include head.	004624	\$330.00

## Drive Heads



ORDER NO.	DESCRIPTION	STOCK	RETAIL
DC880666	Drive head with bearing for IH 820 Platforms. (Kondex 901-041)	56967	\$99.50
K920223	Replacement bearing for DC880666, requires 2 per head. Replaces IH no. 176699C91.	98142	\$59.84
H150090	Drive head for Case-IH 1020 with a 3" cutting system.	03098	\$129.00

## Kits for OEM Cutterbar Rebuild

This kit contains all required parts to rebuild a current 3" cutting system or convert a cutterbar back to the OEM style 3" cutting system. Includes sickle, drivehead, guards, holddowns, and bolts.

ORDER NO.	DESCRIPTION	STOCK	RETAIL
KIH102015	Complete cutterbar kit for C-IH 1020, 15'.	029780	\$1,099.00
KIH1020175	Complete cutterbar kit for C-IH 1020, 17.5'.	0042015	\$1,280.00
KIH102020	Complete cutterbar kit for C-IH 1020, 20'.	0086118	\$1,460.00
KIH1020225	Complete cutterbar kit for C-IH 1020, 22.5'.	0481315	\$1,648.00
KIH102025	Complete cutterbar kit for C-IH 1020, 25'.	0004415	\$1,800.00
KIH102030	Complete cutterbar kit for C-IH 1020, 30'.	0299513	\$1,999.00

## Steel Auger Finger



ORDER NO.	DESCRIPTION	STOCK	RETAIL
CF1320699	Steel auger finger for model 1020. Replaces C-IH no. 1320699C1.	0656	\$7.99

# Combine Sickle Repairs (OEM Style) - Hart Carter

## Sections and Section Bolts

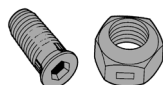

ORDER NO.	DESCRIPTION	STOCK	RETAIL
K112001 (25/box)	Single point section, "Big Tooth", top serrated, countersunk holes. Replaces HCC no. 277444. Fits all Hart Carter floating cutterbars. 3" wide, 2.5" long. Has 2" hole spacing. (Kondex 132-001)	2114	\$1.60
K904525	Countersunk section bolt (5/8") and nut. Box of 50.	0089	\$11.43
K904528	Countersunk section bolt (1") and nut. Box of 25.	7951	\$8.53
K904529	Countersunk section bolt (9/16") and nut. Box of 25.	3667	\$9.47

## Sickles - with bolted sections - for Hart Carter

ORDER NO.	DESCRIPTION	STOCK	RETAIL
K880481	Sickle, 16' with 64 sections, HCC gen 2. With head plate, no drive head. Kondex no. 831-501.	851728	\$387.97

## Guards, Hold Down Clips, Wear Plates for Hart Carter



ORDER NO.	DESCRIPTION	STOCK	RETAIL
BU231	2 prong guard. Replaces HCC no. 234006 & 232155 Agco numbers 71320143, 71176532, 1320143.	46019	\$15.20
SDC468	Steel wear plate, replaces HCC no. 234140.	3318	\$1.90
K515016	Hold down clip, cast. Used on riveted or bolted sickles.	74012	\$14.96

## Sickle Bar Drive Heads for Hart Carter

ORDER NO.	DESCRIPTION	STOCK	RETAIL
C580442	Head Plate, Gen 2. Kondex no. 901-015.	03265	\$89.00
DC88010	Drive head, Gen 2, bolts to sickle.	03432	\$49.00
DC880662	Drive head, Gen 3 with bearing. Replaces HC no. 880662 and Agco no. 71307323. Kondex no. 901-016.	392313	\$189.90
K920223	Replacement bearing for DC880662 drive head. Requires 2 per. Replaces CIH no. 176699C91.	98142	\$59.84



DC880662

## Combine Sickle Repairs (OEM Style) - John Deere

### Sections and Section Bolts

ORDER NO.	DESCRIPTION	STOCK	RETAIL
K412021	Single point section, top serrated, chrome, heavy small tooth. Replaces JD no. H130478 "Dura Cut". 3" wide, 3 9/32" long. 2 holes on 2 1/16" spacing. Bolt-on or rivet-on. (25/box)	1118	\$1.59
K432321	Single point section, top serrated, chrome, "Big Tooth". Replaces JD no. H136807 "Dura Lite". 3" wide, 3 9/32" long. 2 holes on 2 1/16" spacing. Countersunk holes for bolt on sections. (25/box)	387	\$1.19
CH163131	Twin point section to fit JD600 series cutting systems. Replaces JD no. H163131. (25/box)	7415	\$2.10
KDC55	Section bolts and nuts. 5/8" long, box of 50.	8465	\$9.26
KDC5501	Section bolts and nuts, 1" long box of 25.	8744	\$6.83
KDC55114	Section bolts and nuts, 1 1/4" long box of 25.	4253	\$7.50

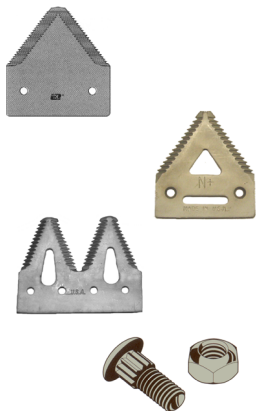

## Drive Heads



ORDER NO.	DESCRIPTION	STOCK	RETAIL
DCAH89498	Drivehead for 200/900 series.	38966	\$99.90
DCAH220051	Drivehead for 600 series. Replaces JD number AH220051.	39266	\$89.90
DCH157812JD	Nylon sleeve for 600 series drive head.	0486	\$12.00

## Guards, Hold Down Clips, Wear Plates



ORDER NO.	DESCRIPTION	STOCK	RETAIL
BU240	2 prong guard, heat treated. Replace John Deere numbers H61954, H75386, H145791. Used on 200 and 900 series.	2188	\$11.60
BU340	3 prong guard, heat treated. Replaces JD no. H25603. Used on 200 and 900 series.	72315	\$18.95
BU610	Guard for 600 series heads. Has 2 long and 1 short prong. Replaces JD H205448, H213398.	37115	\$16.75
BU615	Guard for 600 series heads. Has 1 long and 2 short prong. Replaces JD H213507, AH205482, AH213055, H205447, 213400.	37115	\$16.75
BU620	Standard arch hold down clip, adjustable. Fits 600F, 600FD, 600R, 925D, 930D, 936D. Replaces JD No AH218547.	3148	\$5.90
BU625	Adjustable hold down clip for 600 series. Replaces JD AH213058, AH218548.	3840	\$6.90
K5116	Steel hold down clip, fits all 200 and 900 series flex heads and early rigid heads. For use with riveted or bolted sickles.	9131	\$4.56
K127801	Cast hold down clip, fits all 200 and 900 series flex heads. For use with riveted or bolted sickles. Replaces JD no. H127801.	0126	\$2.99
BDC5150H	Extra high arch hold down clip for use at drive head area. Fits all flex heads and early rigid headers. Used on 200 and 900 series.	3335	\$4.76
SDC468	Steel wear plate, replaces JD no. E47954. Used on 200 and 900 series.	2118	\$1.60

## Sickles (200/900 series) - Split, without drive head - Can ship UPS

ORDER NO.	DESCRIPTION	STOCK	RETAIL
CR19358	Split sickle, 13' with big tooth sections.	006718	\$220.00
CR19359	Split sickle, 15' with big tooth sections, for 215.	002918	\$240.00
CR28084	Split sickle, 15' with big tooth sections, for 915.	002917	\$240.00
CR19360	Split sickle, 16' with big tooth sections.	008021	\$260.00
CR19361	Split sickle, 18' with big tooth sections.	000421	\$300.00
CR19362	Split sickle, 20' with big tooth sections.	004621	\$330.00
CR19363	Split sickle, 22' with big tooth sections.	006922	\$370.00
CR19364	Split sickle, 24' with big tooth sections.	008233	\$410.00
CR28777	Split sickle, 25' with big tooth sections.	002331	\$415.00
CR19365	Split sickle, 30' with big tooth sections.	008635	\$460.00

## Sickles (600 series) - Split, without drive head - Can ship UPS

ORDER No.	DESCRIPTION	STOCK	RETAIL
S354609	Split sickle, 20' with big tooth sections.	563921	\$419.50
S354610	Split sickle, 25' with big tooth sections.	380735	\$529.75
S354611	Split sickle, 30' with big tooth sections.	031648	\$659.00
S354612	Split sickle, 35' with big tooth sections.	794255	\$749.95

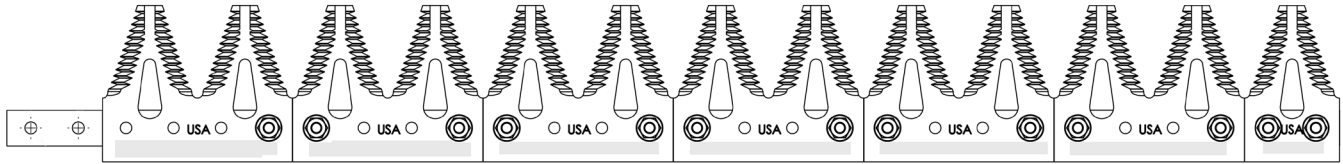

## Kits for OEM Cutterbar Rebuild for 200 & 900 Series

This kit contains all required parts to rebuild a current 3" cutting system or convert a cutterbar back to the OEM style 3" cutting system. Includes drivehead, sickle, guards, wear plates, holddowns, and hardware.

ORDER No.	DESCRIPTION	STOCK	RETAIL
KJD913	Complete cutterbar kit for JD 213 & 913 flex heads.	527648	\$623.00
KJD915	Complete cutterbar kit for JD 215 & 915 flex heads.	529051	\$679.00
KJD918	Complete cutterbar kit for JD 218 & 918 flex heads.	529954	\$799.00
KJD920	Complete cutterbar kit for JD 220 & 920 flex heads.	529568	\$879.00
KJD922	Complete cutterbar kit for JD 222 & 922 flex heads.	341276	\$961.90
KJD925	Complete cutterbar kit for JD 925 flex heads.	968085	\$1,078.25
KJD930	Complete cutterbar kit for JD 930 flex heads.	369599	\$1,279.50

## Steel Auger Finger and Guide



ORDER No.	DESCRIPTION	STOCK	RETAIL
CF162662	Steel auger finger. Replaces JD no. H162662.	9846	\$6.99
P87192	Finger guide plate cover. Replaces JD no. H87192.	3316	\$1.90
P87044	Finger guide. Replaces JD no. H87044.	5019	\$1.50
P179000	Finger guide for OEM JD poly fingers. Replaces JD H179000.	3025	\$2.90



P87192



P87044



P179000

# Combine Sickle Repairs (OEM Style) - Lexion

## Guards, Hold Down Clips



ORDER No.	DESCRIPTION	STOCK	RETAIL
BU209	Guard, 2 prong without crossbar. Replaces Lexion number 7672651.	4993	\$14.20
BU626	Guard, 2 prong with crossbar. Replaces Lexion 6267290.	8689	\$12.40
K5116	Hold down clip.	9131	\$4.56

# Combine Sickle Repairs (OEM Style) - New Holland

## Sections and Section Bolts



ORDER No.	DESCRIPTION	STOCK	RETAIL
K231271 (25/box)	Section, black, top serrated, Big Tooth. Fits 970, 971, 972, and 973 series.	098	\$1.29
BDC6700B (25/box)	Double point section. 7 serrations per inch, chrome. Fits all NH cutterbars with 1-1/2" cutting system.	887	\$1.25
KDC55	Section bolts and nuts, for use with single point sections, 5/8" long, box of 50.	8465	\$9.26
KDC5501	Section bolts and nuts, 1" long box of 25.	8744	\$6.83
KDC55114	Section bolts and nuts, for use with single point sections, 1-1/4" long, box of 25.	4253	\$7.50

## Guards, Hold Down Clips, Wear Plates



ORDER No.	DESCRIPTION	STOCK	RETAIL
BU215	Double prong guard with cross bar. Used on 971, 973, 71C, 73C; 72C and 74C to s/n PNL017000 and all s/n's that start with HAJ. Replaces NH no's. 2199191, 858778, 86521587, 86553340, 86615982.	7198	\$13.10
BU299	Double prong guard without crossbar. Used on 72C and 74C with s/n PNL017001 and above. Replaces NH no. 87442324.	3097	\$12.90
BU329	Double prong head guard without crossbar. 2 used per head. Used on 72C and 74C with s/n PNL017001 and above. Replaces 87442329.	34018	\$14.90
BU245	Double prong guard. Used on 970, and 972 series. Replaces NH no. 65327.	4298	\$13.20
K800	Hold down clip. Fits for single drive 970, 971, 972, 973, 71C, and 73C series.	0925	\$4.14
BDC5150H	High arch hold down clip for use at the drive head area. Fits all flex heads and early rigid heads.	4635	\$5.20

# Combine Sickle Repairs (OEM Style) - MacDon

## Sections and Section Bolts

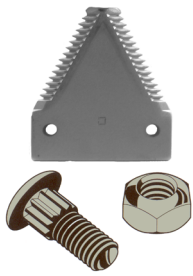

ORDER No.	DESCRIPTION	STOCK	RETAIL
K232011	Section, extra heavy, chrome, top serrated, Big Tooth. Fits 960, 962, 972; Case-IH 1042, 1052, 2042, 2052, 2062, New Holland 84C. 10/box.	5718	\$2.50
KDC55	Section bolts and nuts, for use with single point sections, 5/8" long, box of 50.	8465	\$9.26
KDC5501	Section bolts and nuts, 1" long box of 25.	8744	\$6.83
KDC55114	Section bolts and nuts, for use with single point sections, 1-1/4" long, box of 25.	4253	\$7.50

## Guards, Hold Down Clips, Wear Plates



ORDER No.	DESCRIPTION	STOCK	RETAIL
BU344	Double prong guard. Fits 960, 962, 972; Case-IH 1042. Replaces MacDon no. 23064 & 28013.	8685	\$12.40
BU345	Drive head guard. Fits MacDon 960, 962, 963, 972, 973, 974, D40, D50, FD70 Drapers; 3000, 3020, 4000, 5000, 5010, 5020, 7000, 8000, 9000, series Windrowers/Conditioners; 910, 912, 920, 922, 930, 942, A30S, A30D, A40D Auger Headers; Case-IH 1042, 1052, 2042, 2052, 2062, 2142, 2152, 2162 Drapers; John Deere 140 Auger; 160 Draper; 590 Windrower; New Holland 84C, 86C Drapers; White 601, 6200 Windrower. Replaces MacDon 28014, 118345.	1394	\$13.30

# Combine Sickle Repairs (OEM Style) - Love Floating

## Sections and Section Bolts

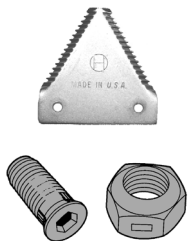

ORDER No.	DESCRIPTION	STOCK	RETAIL
K212121 (25/box)	Section, chrome, "Big Tooth", heavy, top serrated with countersunk holes on 2" spacing. Replaces Love no. L192DC. 3" wide by 3" long. Fits all Love prior to 1979.	098	\$1.29
K904525	Countersunk bolt and lock nut, 5/8" long. Box of 50.	0088	\$11.43
K904528	Countersunk bolt and lock nut, 1" long. Box of 50.	7958	\$8.53

## Guards, Hold Down Clips, Wear Plates



ORDER No.	DESCRIPTION	STOCK	RETAIL
BU275	Double prong guard, replaces Love LB208 and LB214. Replaces MF number 1036339M1, and NH numbers 271971 and 273846. Fits all Love floating cutterbars.	9096	\$12.99
SDC468	Steel wear plate, replaces Love no. 220. Fits all Love floating cutterbars.	3318	\$1.90
K515016	Hold down clip, cast. Used on riveted or bolted sickles.	74012	\$14.96

## Sickles - Split sickle with bolted sections

ORDER NO.	DESCRIPTION	STOCK	RETAIL
CR19463	Sickle, 15' with "Big Tooth" sections.	000028	\$250.00
CR19464	Sickle, 16' with "Big Tooth" sections.	006124	\$270.00
CR19466	Sickle, 20' with "Big Tooth" sections.	002725	\$340.00

## Sickle Bar Drive Head

ORDER NO.	DESCRIPTION	STOCK	RETAIL
DCLOVE	Drive head with stabilizer bar.	00240	\$60.00

## Mower / Conditioner Parts



K231271

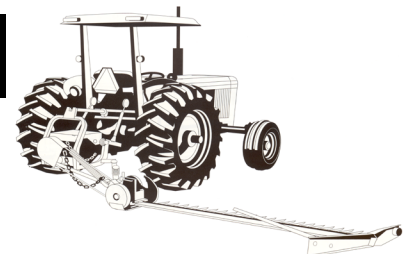

## Sickle Sections

ORDER NO.	DESCRIPTION	STOCK	RETAIL
K211022 (25/box)	Section, underserrated, black, heavy section. Fits John Deere mowers and mower conditioners except 140, 160, 580, & 590. Fits all Ford mowers except model 505.	478	\$1.06
K212082 (25/box)	Section, underserrated, chrome, heavy section. Fits John Deere mowers and mower conditioners except 140, 160, 580, & 590. Fits all Ford mowers except model 505.	9218	\$1.84
K212241 (25/box)	Section, chrome, top serrated, extra heavy, "Big Tooth". Fits JD mowers and mower conditioners except 140, 160, 580, & 590. Fits all Ford mowers except model 505.	6118	\$1.66
K231271 (25/box)	Section, black, Big Tooth, extra heavy, top serrated. Fits Case-IH, Ford, New Holland, New Idea, Hesston, Gehl/Owatonna.	097	\$1.29

## Bolts for Sections

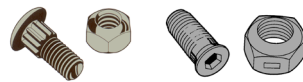

ORDER NO.	DESCRIPTION	STOCK	RETAIL
KDC55	Section bolts and nuts, 5/8" long, box of 50.	8465	\$9.26
KDC5501	Section bolts and nuts, 1" long, box of 25.	8744	\$6.83
KDC55114	Section bolts and nuts, 1-1/4" long, box of 25.	4253	\$7.50
K904525	Countersunk bolt and lock nut, 5/8" long. Box of 50.	0088	\$11.43
K904528	Countersunk bolt and lock nut, 1" long. Box of 50.	7958	\$8.53
KBDC174	Section bolts and nuts, 1/4" x 5/8", 50 pcs.	9874	\$11.25
KBDC174N	Section nuts, 1/4" self locking, 50 pcs.	5243	\$6.01